

**HOTEL RESERVATION FORM**  
**THE SECOND ANNUAL ARAB ASIAN FINANCIAL FORUM**  
**5TH – 6TH SEPTEMBER 2007**



Palace of the Golden Horses, Asia's most extraordinary hotel, with 480 rooms and suites offers a harmonious blend of Moorish architecture and is situated just minutes from Kuala Lumpur city centre.

We have been the host venue for several prestigious international events namely, G-15-1997, APEC 1998, NAM Summit 2003, OIC Summit 2003, the recent FEI World Horse Jumping 2005/6, Gourmand World Media Awards 2005/6 and ASEANAPOL Conference 2006, 9th Fespac Games 2006 and GIFA (Global Indian Film Awards) 2006. Being a recipient of numerous awards including the Best , M.I.C.E. Hotel and Best Concierge by World Asia Media 2003/04 has also poised Palace of the Golden Horse above all hotels.

Web : [www.palaceofthegoldenhorses.com.my](http://www.palaceofthegoldenhorses.com.my)

Hotel	Type of Rooms	Rates	Contact Persons
PALACE OF THE GOLDEN HORSES	Deluxe <input type="checkbox"/>	RM320.00++	MR AARON TAN TEL : 00603 8943 2333 FAX : 00603 8941 1470 FAX : 00603 8944 3425 EMAIL : aarontan@pgh.mines.com.my
	Executive Suite <input type="checkbox"/>	RM550.00++	
	Minister Suite <input type="checkbox"/>	RM1,100.00++	

Room reservation request is to be sent directly to the hotel and is subject to Room availability. Please fax or mail this reservation form to secure your room.

- Rates are quoted in Ringgit Malaysia inclusive of 10% Service Charge & 5% Government Tax
- Rates quoted are based on Room & breakfast (Single or Twin Sharing)

Name : \_\_\_\_\_

Arrival date:	Limousine pick-up at ( Y / N ) RM 250 nett per way	Flight # Time
Departure date :	Limousine send off at ( Y / N ) RM 250 nett per way	Flight # Time

• The Hotel official check-in time is 1400 hours onwards and check-out time is 1200 noon on the day of departure.

• In the event of any request for guaranteed early check-in before 1200 noon, a 50% surcharge will be applicable, while a full-day surcharge will be applicable for guaranteed check-in before 0900 hours.

• Late check-out will be on a request basis and subject to availability. A half-day room charge is applicable for late check-out until 1800 hours. Rooms occupied beyond 1800 hours will be charged at a full day rate.

• A one-night room charge will be imposed for any no-shows or cancellation within 48 hours prior to arrival

Credit Card Type:                      Visa                       Master                       \*Amex                       JCB                       Diners   
(please tick)

\* For AMEX card, please provide the 4 digit ID Number displayed at the front card \_\_\_\_\_

Credit Card no : \_\_\_\_\_ Expiry date : \_\_\_\_\_ Signature : \_\_\_\_\_

Credit Card ID : \_\_\_\_\_

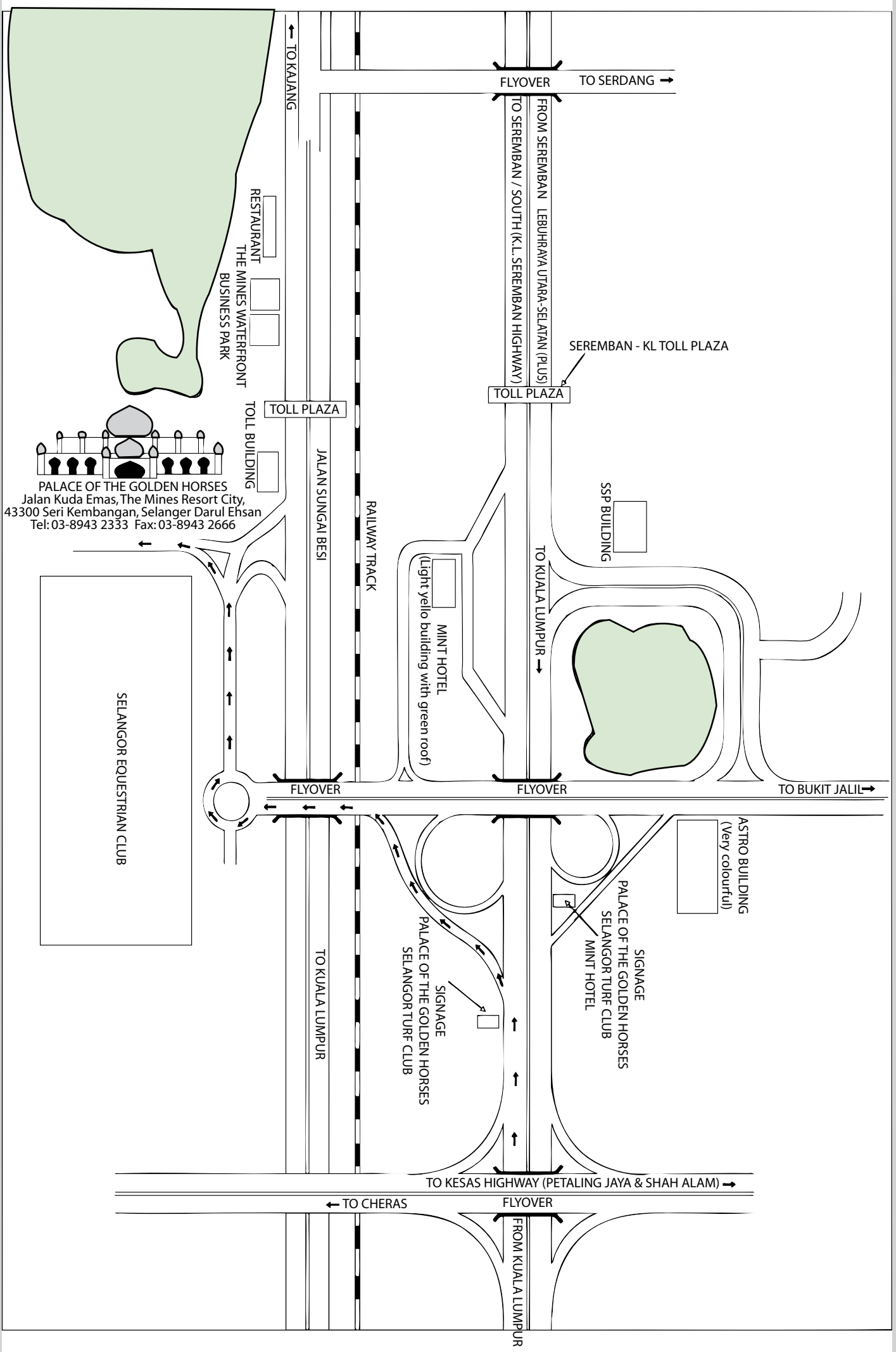

**PALACE OF THE GOLDEN HORSES**  
 Jalan Kuda Emas, The Mines Resort City,  
 43300 Seri Kembangan, Selangor Darul Ehsan  
 Tel: 03-8943 2333 Fax: 03-8943 2666

**FROM KUALA LUMPUR TO PALACE OF THE GOLDEN HORSES**